

# SCHEMATIC & PARTS LIST

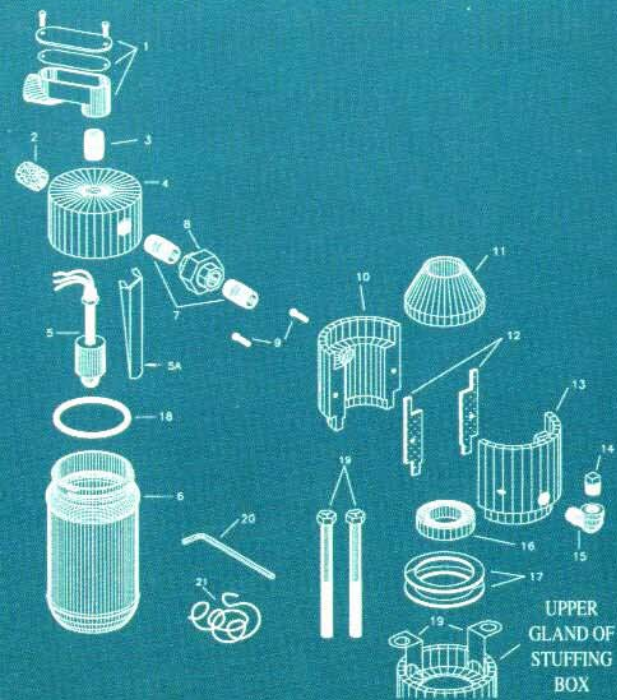

- 1: ELECTRICAL CONNECTION BOX, GASKET & COVER
- 2: INSECT GUARD
- 3: 1/2" CLOSE NIPPLE
- 4: RESERVOIR HOLDER
- 5: LIQUID LEVEL SWITCH
- 5A: FLOAT SHIELD
- 6: CLEAR RESERVOIR
- 7: 3/4" X 1-1/2" NIPPLE (2)
- 8: 3/4" UNION
- 9: 1/4 - 20 CAP SCREWS (2)
- 10: RESERVOIR HALF ADAPTER
- 11: PACKING CONE
- 12: ADAPTER SIDE SEALS (2)
- 13: LUBRICATION HALF OF ADAPTER
- 14: LUBRICATING OIL FILL PLUG, 1/2" NPT
- 15: LUBRICATING OIL FILLER (1/2" STREET ELBOW)
- 16: CROWN RING (USED WITH GREASE)
- 17: LOWER ADAPTER SEALS (2)
- 18: RESERVOIR SEAL RING
- 19: 3/8" X 6" BOLTS, WASHERS, NUTS, BOLT RETAINERS (2 EACH)
- 20: 3/16" ALLEN WRENCH
- 21: STRING



U.S. Patent No. 5,148,699

# SAVE TIME SAVE MONEY

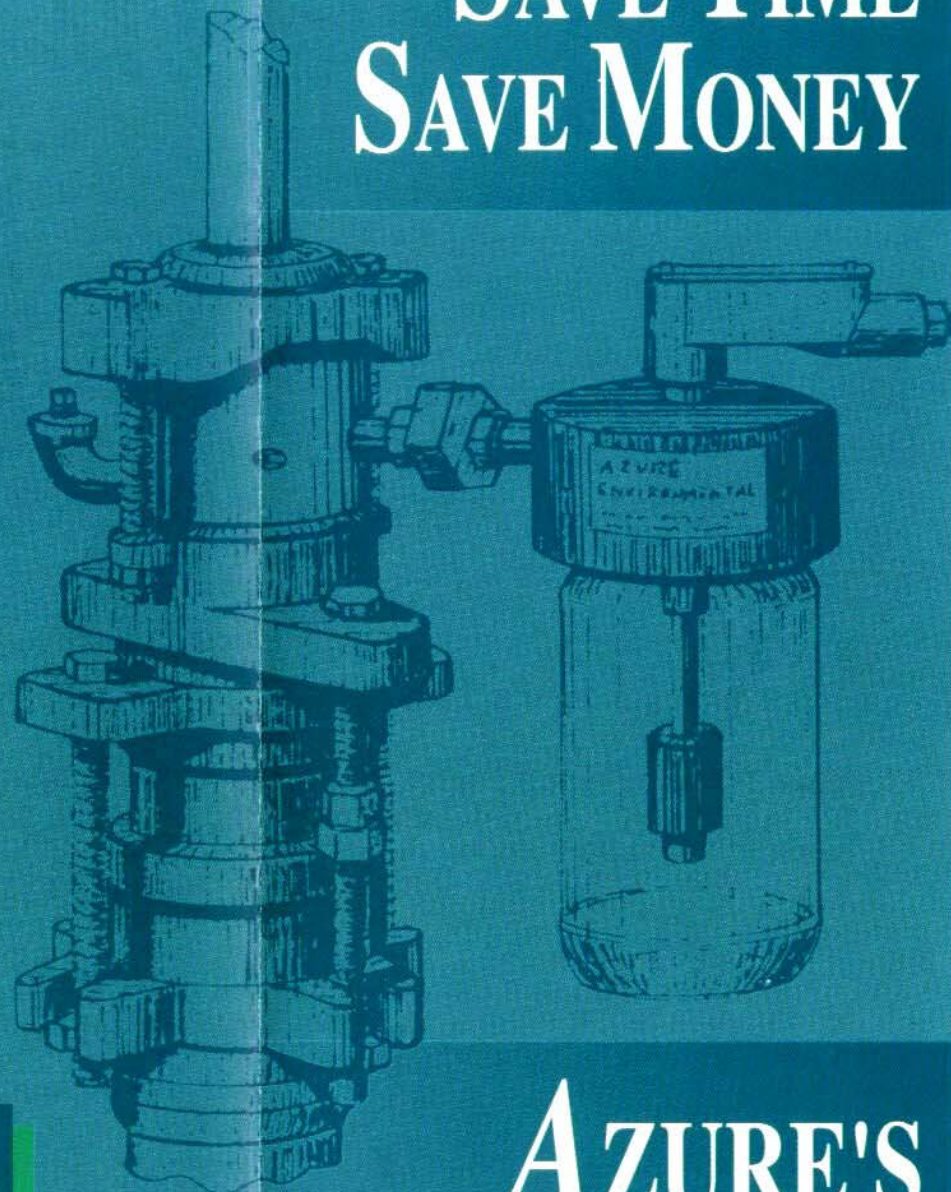

# AZURE

Environmental, Ltd.

Tulsa, Oklahoma  
1-800-492-4393

# AZURE'S STUFFING BOX LEAK DETECTOR



# AZURE'S STUFFING BOX LEAK DETECTOR . . . *savings you can see!*

## WHY YOU NEED ONE

What did clean up of your last stuffing box leak cost? Even a small leak could cost several hundred dollars - thousands of dollars for a major leak. How much money is lost while the pumping unit is shut down for clean up?

Installed cost of Azure's Stuffing Box Leak Detector should be less! With Azure's Stuffing Box Leak Detector, leakage is detected earlier, so little or no clean up is needed.

It saves you time - it saves you money.  
The choice is clear.

## HOW IT WORKS

Stuffing box leak detectors prevent pollution resulting from leakage of fluids past the sealing members of stuffing boxes on rod pumped wells.

With the stuffing box leak detector leaking fluids are caught in the reservoir, tripping the switch and shutting down the pumping unit.

## START SAVING TODAY

Telephone: 1-918-712-2727 Fax: 1-918-747-6131

Toll-free numbers in USA & Canada

Telephone: 1-800-492-4393 Fax: 1-877-747-6132

## SPECIAL FEATURES

- A clear reservoir temporarily holds leaking fluid, allowing for early detection.
- The reservoir removes easily for cleaning.
- Only corrosion resistant components are used in Azure's leak detectors.
- A long travel float switch is a standard feature.
- Switch options include explosion proof, intrinsically safe, or no moving parts.



## EASY TO INSTALL

The split adapter allows for easy installation on the wellhead without a workover rig or a boom truck. Adapter is compact to minimize clearance or misalignment problems.

The standard adapter is strong enough to support the weight of the rod string and will fit most stuffing boxes including Huber and Skinner cone boxes, Skinner X type and Lube Top Jack. Custom adapters to fit other stuffing box designs are available upon request.